

Doppelnippel
- Rotguss oder Siliziumbronze
Modell 3280

| Artikel | R | VCR | L | SW |
|---------|-------|-----|----|----|
| 441 401 | 1/8 | | 18 | 10 |
| 320 416 | 1/4 | | 20 | 14 |
| 282 356 | 3/8 | | 29 | 18 |
| 266 592 | 1/2 | | 37 | 22 |
| 266 615 | 3/4 | | 40 | 27 |
| 266 608 | 1 | | 45 | 34 |
| 269 135 | 1 1/4 | | 53 | 44 |
| 269 111 | 1 1/2 | | 52 | 50 |
| 269 098 | 2 | | 65 | 65 |
| 321 741 | 2 1/2 | | 78 | 80 |
| 321 789 | 3 | | 85 | 95 |

VCR = verchromt
SW = Schlüsselweite

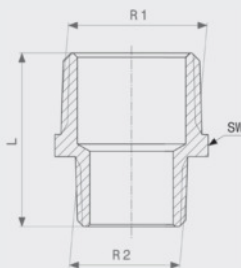

Reduziernippel
- Rotguss oder Siliziumbronze
Modell 3245

| Artikel | R1 | R2 | L | SW |
|---------|-------|-------|----|----|
| 441 364 | 1/4 | 1/8 | 24 | 14 |
| 282 127 | 3/8 | 1/4 | 28 | 18 |
| 319 526 | 1/2 | 1/4 | 31 | 22 |
| 266 530 | 1/2 | 3/8 | 32 | 22 |
| 319 113 | 3/4 | 3/8 | 34 | 27 |
| 266 523 | 3/4 | 1/2 | 37 | 27 |
| 320 287 | 1 | 1/2 | 40 | 34 |
| 266 547 | 1 | 3/4 | 42 | 34 |
| 320 119 | 1 1/4 | 3/4 | 46 | 44 |
| 269 173 | 1 1/4 | 1 | 49 | 44 |
| 321 697 | 1 1/2 | 1 | 52 | 50 |
| 269 159 | 1 1/2 | 1 1/4 | 54 | 50 |
| 441 371 | 1 3/4 | 1 1/2 | 47 | 55 |
| 320 270 | 2 | 1 1/4 | 58 | 61 |
| 321 680 | 2 | 1 1/2 | 59 | 61 |
| 650 803 | 2 1/2 | 2 | 70 | 76 |
| 443 177 | 3 | 2 1/2 | 77 | 90 |

SW = Schlüsselweite

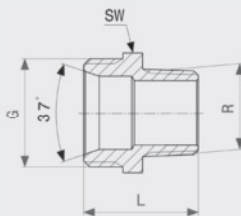

Übergangsnippel
- Rotguss oder Siliziumbronze
Modell 3246

| Artikel | R | G | VCR | L | SW |
|---------|-------|-------|-----|----|----|
| 441 517 | 3/8 | 1/2 | | 25 | 22 |
| 449 339 | 1/2 | 1/2 | | 30 | 22 |
| 441 524 | 1/2 | 3/4 | | 21 | 27 |
| 449 346 | 3/4 | 3/4 | | 33 | 28 |
| 446 765 | 1/2 | 1 | | 33 | 34 |
| 441 531 | 3/4 | 1 | | 35 | 34 |
| 446 772 | 1 | 1 | | 39 | 34 |
| 446 789 | 1 | 1 1/4 | | 39 | 44 |
| 446 796 | 1 1/4 | 1 1/2 | | 45 | 50 |
| 446 802 | 1 1/2 | 1 3/4 | | 47 | 55 |
| 441 388 | 2 | 2 3/8 | | 54 | 71 |

VCR = verchromt
SW = Schlüsselweite