

Muffe
- Rotguss oder Siliziumbronze
Modell 3270

| Artikel | Rp | VCR | L | SW |
|---------|-------|-----|----|-----|
| 441 395 | 1/8 | | 16 | 14 |
| 319 137 | 1/4 | | 18 | 17 |
| 282 349 | 3/8 | | 23 | 21 |
| 266 585 | 1/2 | | 30 | 26 |
| 266 554 | 3/4 | | 33 | 32 |
| 266 561 | 1 | | 38 | 38 |
| 266 578 | 1 1/4 | | 43 | 50 |
| 267 766 | 1 1/2 | | 43 | 57 |
| 267 780 | 2 | | 59 | 70 |
| 271 916 | 2 1/2 | | 61 | 83 |
| 271 930 | 3 | | 67 | 103 |

VCR = verchromt
SW = Schlüsselweite

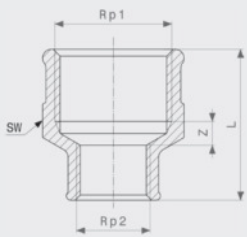

Reduziermuffe
- Rotguss oder Siliziumbronze
Modell 3240

| Artikel | Rp1 | Rp2 | VCR | Z | L | SW |
|---------|-------|-------|-----|----|----|----|
| 282 103 | 3/8 | 1/4 | | 3 | 26 | 21 |
| 318 031 | 1/2 | 1/4 | | 5 | 31 | 26 |
| 268 879 | 1/2 | 3/8 | | 5 | 31 | 26 |
| 266 370 | 3/4 | 3/8 | | 5 | 34 | 31 |
| 268 862 | 3/4 | 1/2 | | 5 | 32 | 31 |
| 266 363 | 1 | 1/2 | | 13 | 34 | 26 |
| 266 356 | 1 | 3/4 | | 7 | 36 | 38 |
| 266 431 | 1 1/4 | 3/4 | | 8 | 45 | 47 |
| 266 417 | 1 1/4 | 1 | | 6 | 49 | 47 |
| 271 879 | 1 1/2 | 3/4 | | 10 | 41 | 53 |
| 267 520 | 1 1/2 | 1 | | 8 | 48 | 53 |
| 266 394 | 1 1/2 | 1 1/4 | | 5 | 47 | 53 |
| 271 893 | 2 | 1 1/4 | | 2 | 50 | 66 |
| 267 544 | 2 | 1 1/2 | | 0 | 47 | 66 |
| 271 855 | 2 1/2 | 2 | | 16 | 58 | 83 |
| 650 780 | 3 | 2 1/2 | | 27 | 67 | |

VCR = verchromt
SW = Schlüsselweite

GEWINDEVERBINDER AUS ROTGUSS ODER SILIZIUMBRONZE
NIPPEL, ÜBERGÄNGE, VERLÄNGERUNGEN

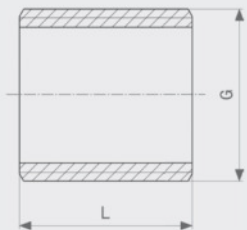

Nippel
- Rotguss oder Siliziumbronze
Modell 3531

| Artikel | G | L |
|---------|-------|----|
| 322 076 | 1/4 | 20 |
| 322 113 | 3/8 | 20 |
| 322 106 | 1/2 | 22 |
| 322 090 | 3/4 | 26 |
| 322 083 | 1 | 33 |
| 322 144 | 1 1/4 | 37 |
| 322 137 | 1 1/2 | 42 |
| 322 120 | 2 | 47 |